

How does the solar power lamp sense



Overview

While solar lights work best with direct sunlight, they can also charge from ambient light, though much less efficiently. How It Works (Photovoltaic Effect): This process is called the "photovoltaic effect. " Solar panels are made of multiple layers of crystalline silicon and chemicals that create. These lamps harness the power of the sun to provide illumination without the need for traditional electricity. All you need to do is to put them in a sunny spot and that's it. They offer a green, renewable source of energy that reduces electricity bills and environmental impact. Solar. Traditional lighting fixtures continuously consume power resources and increase carbon emissions.

How does the solar power lamp sense



How Do Solar Lights Work? (2026) , ConsumerAffairs®

Solar lights typically get energy from sunlight, though you may also be able to charge them through an external power source when sunlight is low.

How Do Solar Powered Lights Work - A Guide For Dummies

When night falls and the solar panels stop producing power, a photoresistor detects the drop in light levels. This triggers the system to switch from charging the batteries to using their stored ...



How Solar Outdoor Lamps Work: Understanding the Science Behind It

Solar outdoor lamps often come with a built-in light control system that automatically turns the lamp on at dusk and off at dawn. This system relies on sensors to detect ambient light ...

Solar Lighting Technology

Explained: How Solar Lamps Really Work

Most solar lamps have a light sensor that detects when it gets dark. The sensor activates the LED bulb at dusk, providing light without manual intervention. Solar lamps are designed to ...



The Science Behind Solar Lights: How They Work and Why You ...

Once daylight fades, a photoresistor or light sensor detects the drop in ambient light. This triggers the control circuit to switch the LED light on, drawing power from the battery. The LED then ...

How do solar lights work? Electrical experts reveal

That's because solar lights use light sensors to detect light intensity. Brand Young says ' Most solar panels and appliances, like lights, utilize sensors that are majorly light-dependent ...



How Do Solar Lights Work

Solar lights automatically turn on at night using a built-in light sensor. They use the electricity collected by the solar panels and stored in the battery during the day to power the LED light.



How Solar Lights Work: A Comprehensive Guide

With advancements in solar power system technology, the future of solar lamps for garden and solar street lights looks promising. New developments in battery storage, panel ...

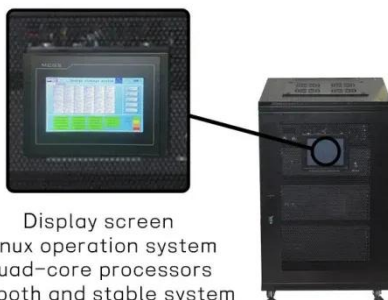

Display screen
Linux operation system
quad-core processors
smooth and stable system

How Do Solar Lights Work? The Ultimate Guide for 2025

Think of a solar light as your yard's personal mini power plant. It collects energy during the day and releases light at night, all without complicated wiring or adding to your electricity bill. In ...

Solar Lamp: Lighting Explained

As dusk approaches, the lamp's controller automatically activates, allowing the battery to power the LED light. This automatic on-off feature not only conserves energy but also ensures

that the lamp ...



Contact Us

For catalog requests, pricing, or partnerships, please visit:
<https://kreatywny-dom.pl>

